

Wilmer Place



Location | Stoke Newington
Client | Reichmann Properties
Status | Construction 2016
Size |

Construction is underway to change a former Carpet Factory behind Stoke Newington High Street, into 32 residential flats.

The former industrial site is located within the Stoke Newington Conservation area, bordering the Abney Park Cemetery.

The existing buildings have been sensitively re-clad in brick slips in order to revitalise the site and make good use of the existing structure and its embodied energy.

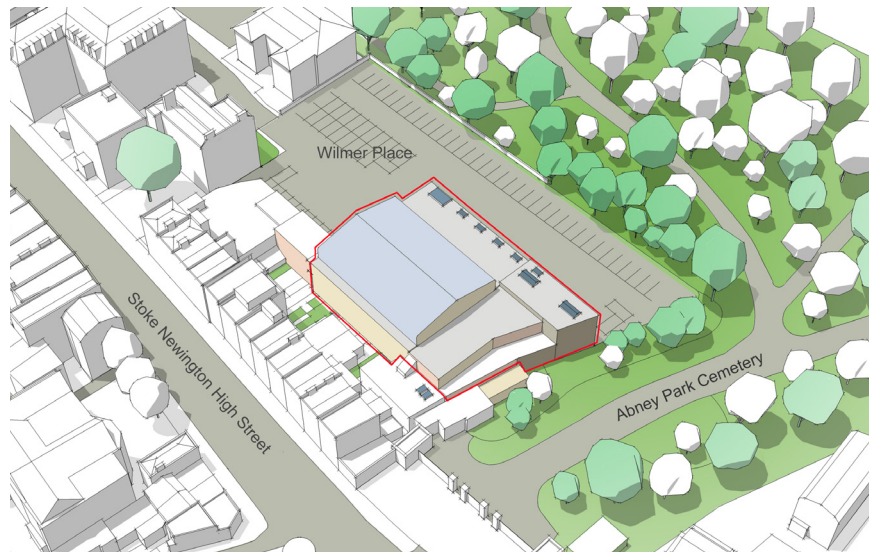

Hale Brown | Architects

Unit 3 - Phoenix Wharf, Eel Pie Island, Twickenham TW1 3DY T: 020 8977 6946 E: mail@halebrown.com W: www.halebrown.com



Wilmer Place



Hale Brown | Architects

Unit 3 - Phoenix Wharf, Eel Pie Island, Twickenham TW1 3DY T: 020 8977 6946 E: mail@halebrown.com W: www.halebrown.com